



**Advanced Communications & Data**  
**KEPS Technologies, Inc. d/b/a ACD.net**  
**FIBER OPTIC CABLE ROUTE**

**Project Number**  
**LC094327FO40345**

[517-999-9999](tel:517-999-9999)

1800 Grand River Ave  
Lansing MI 48906



**CONSTRUCTION NOTES**

1. CONTRACTOR SHALL EMAIL SUNDEN.COLIN@ACD.NET WITH DAILY STATUS UPDATES AND ONCE WORK IS COMPLETE
2. MUNICIPALITY MUST BE NOTIFIED AT LEAST 48 HOURS BEFORE ANY WORK COMMENCES
3. ALL APPROPRIATE PERMITS AND ASSOCIATED DRAWINGS SHALL BE ON-SITE AT ALL TIMES DURING CONSTRUCTION
4. NOTIFY THE APPROPRIATE UTILITY NOTIFICATION SERVICE 72 HOURS PRIOR TO CONSTRUCTION.  
MICHIGAN- MISS DIG (1-800-482-1711), OHIO- O.U.P.S. (1-800-362-2764) OR INDIANA- INDIANA811 (1-800-382-5544)
5. ALL UTILITIES MUST BE FIELD VERIFIED
6. ALL HANDHOLES ARE TO INCLUDE 150' OF COILED FIBER FOR STORAGE
7. NEW INSTALLATION SHALL MAINTAIN 18" CLEARANCE FROM ALL EXISTING UTILITIES UNLESS NOTED OTHERWISE
8. ALL ROAD AND DRIVEWAY CROSSINGS WILL BE DIRECTIONAL BORED
9. CONSTRUCTION SHALL NOT DEVIATE FROM APPROVED PLANS WITHOUT WRITTEN CONSENT FROM BOTH THE MUNICIPALITY AND AN AUTHORIZED ACD.NET REPRESENTATIVE
10. PROPER SIGNAGE AND TRAFFIC CONTROL IS REQUIRED BEFORE STARTING ANY WORK WITHIN THE PUBLIC RIGHT OF WAY
11. ALL BACKFILL MATERIAL WITHIN THE ROAD RIGHT OF WAY OR NEAR SIDEWALKS AND PATHWAYS SHALL MEET THE REQUIREMENTS OF MDOT CLASS II MATERIAL, COMPACTED TO 95% OF ITS MAXIMUM DENSITY IN SUCCESSIVE LAYERS THAT ARE NO MORE THAN 12" THICK, UNLESS OTHERWISE AUTHORIZED
12. ALL SODDED AREAS THAT MAY DISTURBED DURING CONSTRUCTION ARE TO BE RESTORED WITH 3" QUALITY TOP SOIL, SEED AND MULCH
13. ALL CONCRETE/SIDEWALK AREAS THAT MAY BE DISTURBED ARE TO BE RESTORED TO A LIKE OR BETTER CONDITION.
14. CONTRACTOR SHALL PROVIDE AS-BUILTS ON ALL WORK WITHIN 5 BUSINESS DAYS OF COMPLETION

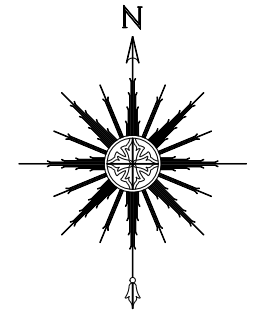

Advanced Communications & Data

517-999-9999

1800 Grand River Ave  
Lansing MI 48906

**PROPRIETARY  
INFORMATION NOT FOR  
DISCLOSURE**

This Set of Plans contains confidential or proprietary information, and the recipient must not disclose, copy, re-create, or distribute the plans or the information contained therein, either directly or indirectly, to other entities or individuals without written or express permission from ACD.NET

**DRAWING DISCLAIMER**

Facility Locations are general in nature, ACD.NET will not be held accountable for the accuracy of the information provided on these drawings.

Contact the Local ONE CALL AGENCY 72 HOURS PRIOR TO CONSTRUCTION FOR EXACT UTILITY LOCATIONS AT:

MISS DIG 1-800-482-7171	O.U.P.S. 1-800-362-2764	INDIANA811 1-800-382-5544
----------------------------	----------------------------	------------------------------

**Project Manager**

C. Sunden

**Permitting**

S. Yohnka

**Transport Manager**

G. Gould

**Drawn By      Date**

DTW                      10/27/23

**As Built      Date**

**Revisions**

REV #	DESCRIPTION	BY	DATE

**Exhibit: N/A**

Remarks:				PEACHTREE ID: 40345	
SCALE: 1" = NTS		TRS:			
COUNTY: Crawford	TOWNSHIP: Grayling	CITY:	PROJECT ID: LC094327FO40345	CUSTOMER NUMBER: 94327	

**NOTES**







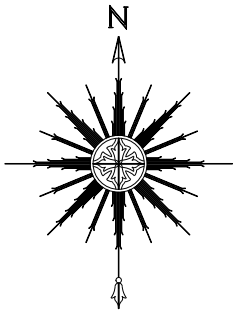

**Advanced Communications & Data**  
 517-999-9999  
 1800 Grand River Ave  
 Lansing MI 48906

**PROPRIETARY  
 INFORMATION NOT FOR  
 DISCLOSURE**

This Set of Plans contains confidential or proprietary information, and the recipient must not disclose, copy, re-create, or distribute the plans or the information contained therein, either directly or indirectly, to other entities or individuals without written or express permission from ACD.NET

**DRAWING DISCLAIMER**

Facility Locations are general in nature, ACD.NET will not be held accountable for the accuracy of the information provided on these drawings.  
 Contact the Local ONE CALL AGENCY 72 HOURS PRIOR TO CONSTRUCTION FOR EXACT UTILITY LOCATIONS AT:

MISS DIG 1-800-482-7171	O.U.P.S 1-800-362-2764	INDIANA811 1-800-382-5544
----------------------------	---------------------------	------------------------------

**Project Manager**

C. Sunden

**Permitting**

S. Yohnka

**Transport Manager**

G. Gould

<b>Drawn By</b>	<b>Date</b>
DTW	10/27/23

<b>As Built</b>	<b>Date</b>

**Revisions**

REV #	DESCRIPTION	BY	DATE

**Exhibit:** N/A

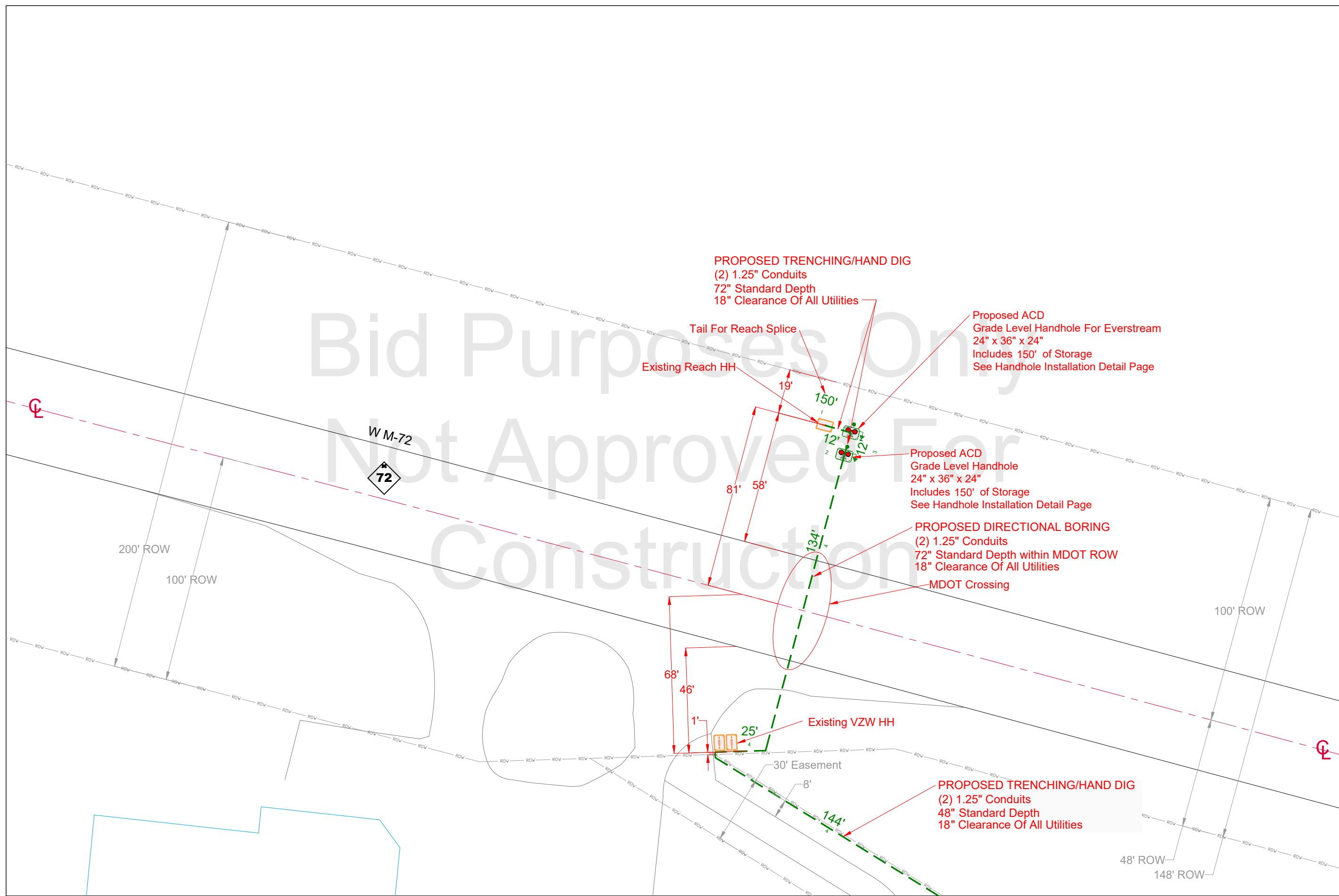

Remarks:			PEACHTREE ID: 40345		
SCALE: 1" = 40'		TRS: S10 T26N R4W			
COUNTY: Crawford	TOWNSHIP: Grayling	CITY:	PROJECT ID: LC094327FO40345	CUSTOMER NUMBER: 94327	
			<b>PG 1</b>		

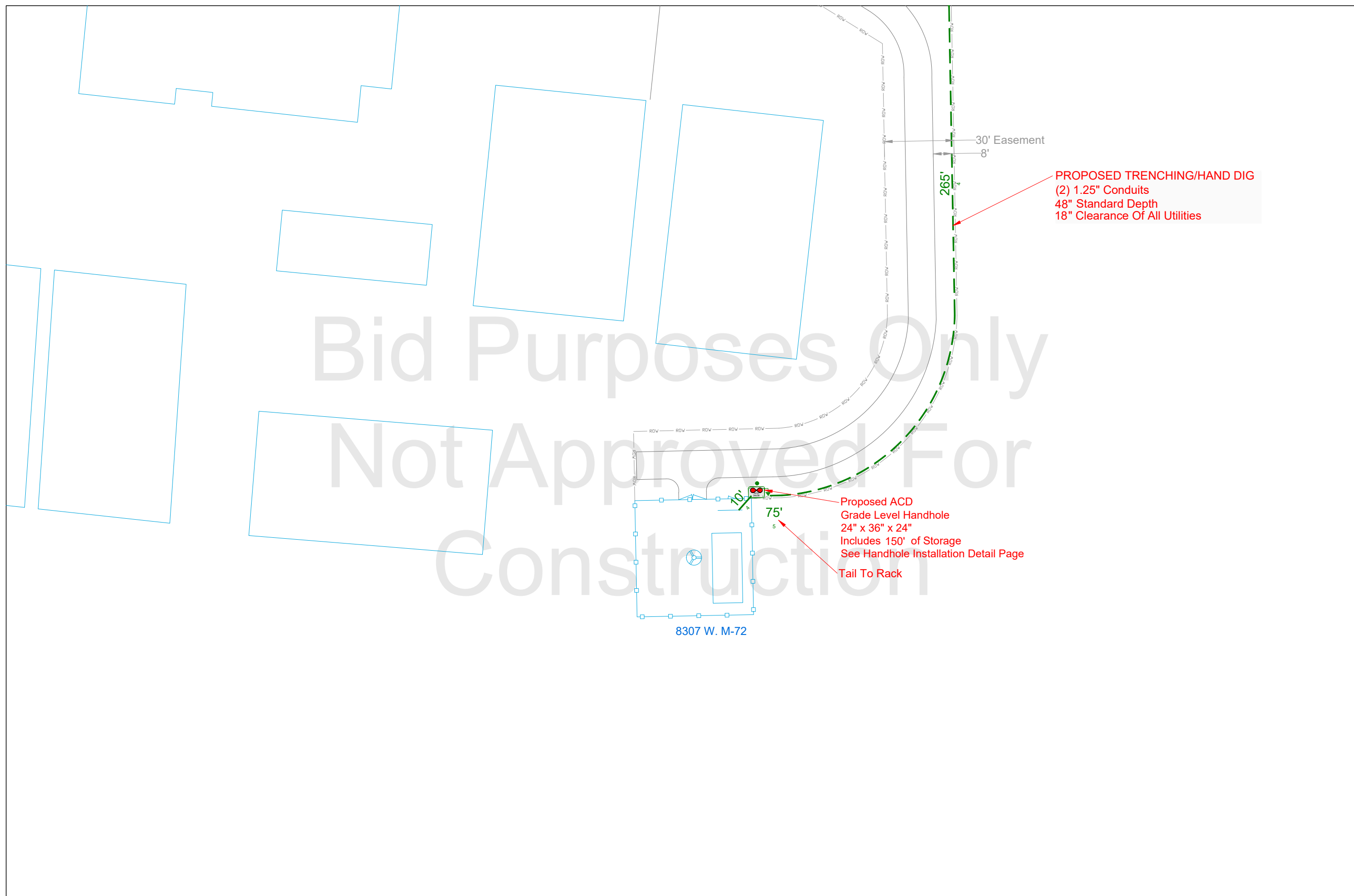

Bid Purposes Only  
 Not Approved For  
 Construction

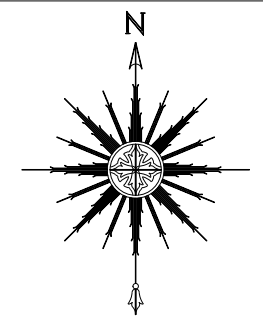

  
**Advanced Communications & Data**  
 517-999-9999  
 1800 Grand River Ave  
 Lansing MI 48906

**PROPRIETARY**  
**INFORMATION NOT FOR**  
**DISCLOSURE**  
This Set of Plans contains confidential or proprietary information, and the recipient must not disclose, copy, re-create, or distribute the plans or the information contained therein, either directly or indirectly, to other entities or individuals without written or express permission from ACD.NET

**DRAWING DISCLAIMER**

Facility Locations are general in nature, ACD.NET will not be held accountable for the accuracy of the information provided on these drawings.  
 Contact the Local ONE CALL AGENCY 72 HOURS PRIOR TO CONSTRUCTION FOR EXACT UTILITY LOCATIONS AT:

<small>MISS DIG</small>	<small>O.U.P.S</small>	<small>INDIANA811</small>
<small>1-800-482-7171</small>	<small>1-800-362-2764</small>	<small>1-800-382-5544</small>

**Project Manager**

C. Sunden

**Permitting**

S. Yohnka

**Transport Manager**

G. Gould

<b>Drawn By</b>	<b>Date</b>
DTW	10/27/23

<b>As Built</b>	<b>Date</b>

**Revisions**

REV #	DESCRIPTION	BY	DATE

**Exhibit:** N/A

Remarks:			PEACHTREE ID: 40345		
SCALE: 1" = 40'	TRS: S10 T26N R4W				
COUNTY: Crawford	TOWNSHIP: Grayling	CITY:	PROJECT ID: LC094327FO40345	CUSTOMER NUMBER: 94327	