



Communications & Data

KEPS Technologies, Inc. d/b/a ACD.net
FIBER OPTIC CABLE ROUTE

Project Number
LC011575FO037972

[517-999-9999](tel:517-999-9999)

1800 Grand River Ave
Lansing MI 48906

CONSTRUCTION NOTES

1. CONTRACTOR SHALL EMAIL __BROWN.TARA@ACD.NET__ WITH DAILY STATUS UPDATES AND ONCE WORK IS COMPLETE
2. MUNICIPALITY MUST BE NOTIFIED AT LEAST 48 HOURS BEFORE ANY WORK COMMENCES
3. ALL APPROPRIATE PERMITS AND ASSOCIATED DRAWINGS SHALL BE ON-SITE AT ALL TIMES DURING CONSTRUCTION
4. NOTIFY THE APPROPRIATE UTILITY NOTIFICATION SERVICE 72 HOURS PRIOR TO CONSTRUCTION.
MICHIGAN- MISS DIG (1-800-482-1711), OHIO- O.U.P.S. (1-800-362-2764) OR INDIANA- INDIANA811 (1-800-382-5544)
5. ALL UTILITIES MUST BE FIELD VERIFIED
6. ALL HANDHOLES ARE TO INCLUDE 150' OF COILED FIBER FOR STORAGE
7. NEW INSTALLATION SHALL MAINTAIN 18" CLEARANCE FROM ALL EXISTING UTILITIES UNLESS NOTED OTHERWISE
8. ALL ROAD AND DRIVEWAY CROSSINGS WILL BE DIRECTIONAL BORED
9. CONSTRUCTION SHALL NOT DEVIATE FROM APPROVED PLANS WITHOUT WRITTEN CONSENT FROM BOTH THE MUNICIPALITY AND AN AUTHORIZED ACD.NET REPRESENTATIVE
10. PROPER SIGNAGE AND TRAFFIC CONTROL IS REQUIRED BEFORE STARTING ANY WORK WITHIN THE PUBLIC RIGHT OF WAY
11. ALL BACKFILL MATERIAL WITHIN THE ROAD RIGHT OF WAY OR NEAR SIDEWALKS AND PATHWAYS SHALL MEET THE REQUIREMENTS OF MDOT CLASS II MATERIAL, COMPACTED TO 95% OF ITS MAXIMUM DENSITY IN SUCCESSIVE LAYERS THAT ARE NO MORE THAN 12" THICK, UNLESS OTHERWISE AUTHORIZED
12. ALL SODDED AREAS THAT MAY DISTURBED DURING CONSTRUCTION ARE TO BE RESTORED WITH 3" QUALITY TOP SOIL, SEED AND MULCH
13. ALL CONCRETE/SIDEWALK AREAS THAT MAY BE DISTURBED ARE TO BE RESTORED TO A LIKE OR BETTER CONDITION.
14. CONTRACTOR SHALL PROVIDE AS-BUILTS ON ALL WORK WITHIN 5 BUSINESS DAYS OF COMPLETION

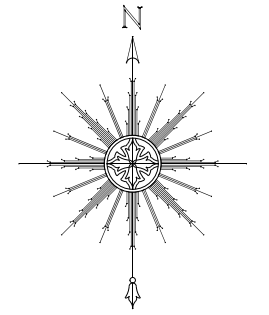

ACD_{NET}
Advanced
Communications & Data
517-999-9999
1800 Grand River Ave
Lansing MI 48906

**PROPRIETARY
INFORMATION NOT FOR
DISCLOSURE**

This Set of Plans contains confidential or proprietary information, and the recipient must not disclose, copy, re-create, or distribute the plans or the information contained therein, either directly or indirectly, to other entities or individuals without written or express permission from ACD.NET

DRAWING DISCLAIMER

Facility Locations are general in nature, ACD.NET will not be held accountable for the accuracy of the information provided on these drawings. Contact the Local ONE CALL AGENCY 72 HOURS PRIOR TO CONSTRUCTION FOR EXACT UTILITY LOCATIONS AT:

<small>MISS DIG 1-800-482-7171</small>	<small>O.U.P.S. 1-800-362-2764</small>	<small>INDIANA811 1-800-382-5544</small>
--	--	--

CAD Standard Ver. 72919

Project Manager

T. Brown

Permitting

T. Brown

Transport Manager

G. Gould

Drawn By Date

K. Ngo 11/30/22

As Built Date

Revisions

REV #	DESCRIPTION	BY	DATE
1	Moved UG Fiber to South Side of Fetch St	KN	12/16/22
2	ROW Revision	KN	01/20/23

Exhibit: N/A

Remarks:			PEACHTREE ID: 37972	
SCALE: 1" = NTS	TRS:			NOTES
COUNTY: Ottawa	TOWNSHIP: Holland	CITY:	PROJECT ID: LC011575FO037972	
			CUSTOMER NUMBER: 11575	

Proposed Anchor Distance and Direction	Reg Sidewalk 	Fiber Count W/ Segment Number 	Man Hole 	Typical Line Types Rail Road Tracks Proposed Underground Fiber Existing Underground Fiber Right Of Way Boundary Side Walk and Driveway Fiber Design Line Aerial Fiber Center Line Water Main Forced Water Main Storm Sewer Sanitary Sewer Gas Main Foreign UG Fiber AT&T UG Fiber UG Electric Oil Line Fence TRS Boundary Civil Boundary Property Boundary Water Boundary
Proposed ACD Communications Poles		Fiber Termination Point 	Storm Drain 	
Proposed ACD NON Communications Pole		ACD Splice Case Six Way 	ACD Regen Cabinet 	
Colocation Poles (ACD Communication Equipment on Existing Poles)		ACD Splice Case Four Way 	TRS Section Corner 	
Joint Use Pole NON Transformer		ACD Splice Case Three Way 	Fire Hydrant 	
Joint Use Pole Transformer		ACD Splice Case Two Way 	Location Address 	
Foreign Pole Indicator		ACD Fiber Tap Capsule 	Foliage 	
Joint Use Pole NON Transformer- UNUSED		ACD RE-Box 	Centerline Marker 	
Joint Use Pole Transformer- UNUSED		Foreign Splice Case 	Station Marker 	
Street Light		Storage Loop w/ Footage and Segment 	Use of Double Dead End 	
Existing Traffic Signal Pole		ACD Buried Cable Marker 		
Pole Number Marker		ACD Hand Hole 17" x 12" 		
Proposed Riser		ACD Hand Hole 24" x 13" 		
Make Ready Symbol w/ Attachment and Sag Heights		ACD Hand Hole 24" x 36" 		
Down Ground		ACD Hand Hole 30" x 48" 		
Bonding Clamp		Foreign Hand Hole 		
Fiber Overlash		Proposed Bore Pit Location 	Bore Pit (size)	
Overhead Guy Marker		Communications Tower 		
Span Length and Segment ID				

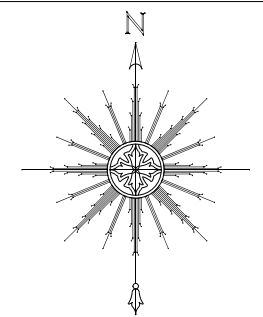

ACD_{NET}
Advanced
Communications & Data
517-999-9999
1800 Grand River Ave
Lansing MI 48906

PROPRIETARY
INFORMATION NOT FOR DISCLOSURE
This Set of Plans contains confidential or proprietary information, and the recipient must not disclose, copy, re-create, or distribute the plans or the information contained therein, either directly or indirectly, to other entities or individuals without written or express permission from ACD.NET

DRAWING DISCLAIMER
Facility Locations are general in nature, ACD.NET will not be held accountable for the accuracy of the information provided on these drawings. Contact the Local ONE CALL AGENCY 72 HOURS PRIOR TO CONSTRUCTION FOR EXACT UTILITY LOCATIONS AT:

MISS DIG 1-800-482-7171	O.U.P.S 1-800-362-2764	INDIANA811 1-800-382-5544
----------------------------	---------------------------	------------------------------

CAD Standard Ver. 72919

Project Manager

T. Brown

Permitting

T. Brown

Transport Manager

G. Gould

Drawn By **Date**

K. Ngo 11/30/22

As Built **Date**

Revisions

REV #	DESCRIPTION	BY	DATE
1	Moved UG Fiber to South Side of Fetch St	KN	12/16/22
2	ROW Revision	KN	01/20/23

Our Match Lines can be found in the lower right hand corner and represents the neighboring page numbers.

WEST PAGE	NORTH PAGE	EAST PAGE
	PAGE	
	SOUTH PAGE	

Exhibit: N/A

Remarks:			PEACHTREE ID: 37972		
SCALE: 1" = NTS	TRS:				
COUNTY: Ottawa	TOWNSHIP: Holland	CITY:	PROJECT ID: LC011575FO037972	CUSTOMER NUMBER: 11575	
				SYMBOLS	
				LEGEND	

General Site Preparation For Installing Hand Holes (All Sizes)

These guidelines for installing ACD Hand holes are provided as a general guide and actual site conditions may warrant the use of additional installations procedures not covered here. Follow all project specifications when installing ACD Hand holes.

1. Excavate the earth approximately 12" wider and longer than the hand hole as well as 6" deeper than the depth of the hand hole. Fill the excavation with a 6" base of pea stone or crushed rock to ensure proper drainage. Tamping is recommended to provide a compact and level surface for the hand hole to be placed upon.
2. Wood bracing should be used inside the hand hole to ensure minimal sidewall deflection when backfilling. Temporary bracing can be constructed out of construction grade lumber. Start by using (1) 2x4 to brace the end walls and (2) 2x4s to brace the side walls, finish with (1) 2x4 from one side of the ring to the other. Do not install the bracing to tight to prevent damage.
3. Lift the Hand hole into the excavation using the lifting bolts or lifting wires. Check the top of the box is flush with the finished grade. Any necessary adjustments should be made to bring it to finished grade.
4. Backfill with clean, loose soil and compact to a minimum of 90%-95% compaction. Remove bracing materials and secure cover using included hardware.

General Hand Hole Notes (All Sizes)

1. All Hand holes are to contain 150' of coiled up storage.
2. All Conduits are to be brought up through the bottom of the hand hole. No Conduits are to penetrate the sides of the enclosure. All conduits are to be tagged with the colored zip ties following this system:
 Red= Riser
 Blue= North
 Yellow= West
 Green= South
 Black= East
3. All Hand holes are to contain a 5/8" DIA x 8' grounding rod to be placed in a corner 3" away from each side and 18" above tamped earth.

Restoration Notes

1. All backfill material within the road right of way or near sidewalks and pathways shall meet the requirements of MDOT Class II material, compacted to 95% of its maximum density in successive layers that are no more than 12" thick, unless otherwise authorized
2. All sodded areas that may be disturbed during construction are to be restored with 3" quality top soil, seed and mulch
3. All Concrete/Sidewalk areas that may be disturbed are to be restored to a like or better condition.

Underground Coupler Detail

PUSH2CONNECT™ Coupler

Do Not Unscrew!

Push-On-Only!
 (Loosening collars prior to installing can cause improper installation, create air loss, or coupler failure)

Air Tight - Water Tight
 Tested to **GREATER THAN 1500#**
Pull-Out
GREATER THAN 450 (psi) air pass-through

Couplers for the Following Sizes	Duct OD	Color	Box Qty	Part Number
1" Smoothwall HDPE	1.315"	Yellow	85	P2C-1.315
1.25" Smoothwall HDPE	1.66"	Blue	100	P2C-1.66
1.25" Smoothwall HDPE True Sized	1.58"	Black	100	P2C-1.58
2" Smoothwall HDPE	2.375"	Orange	24	P2C-2.375
Transition Coupler 1.25" to 1.25"	1.58" to 1.66"	Black AND Blue	100	P2C-1.66-1.58trans

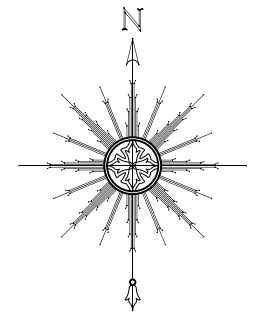
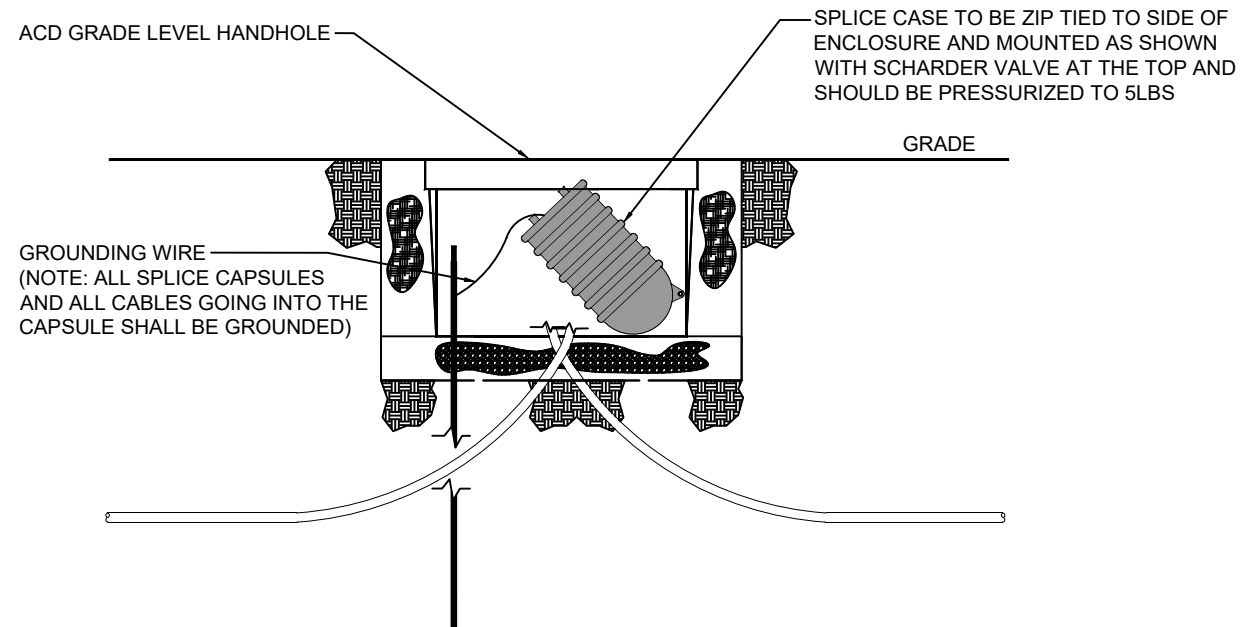
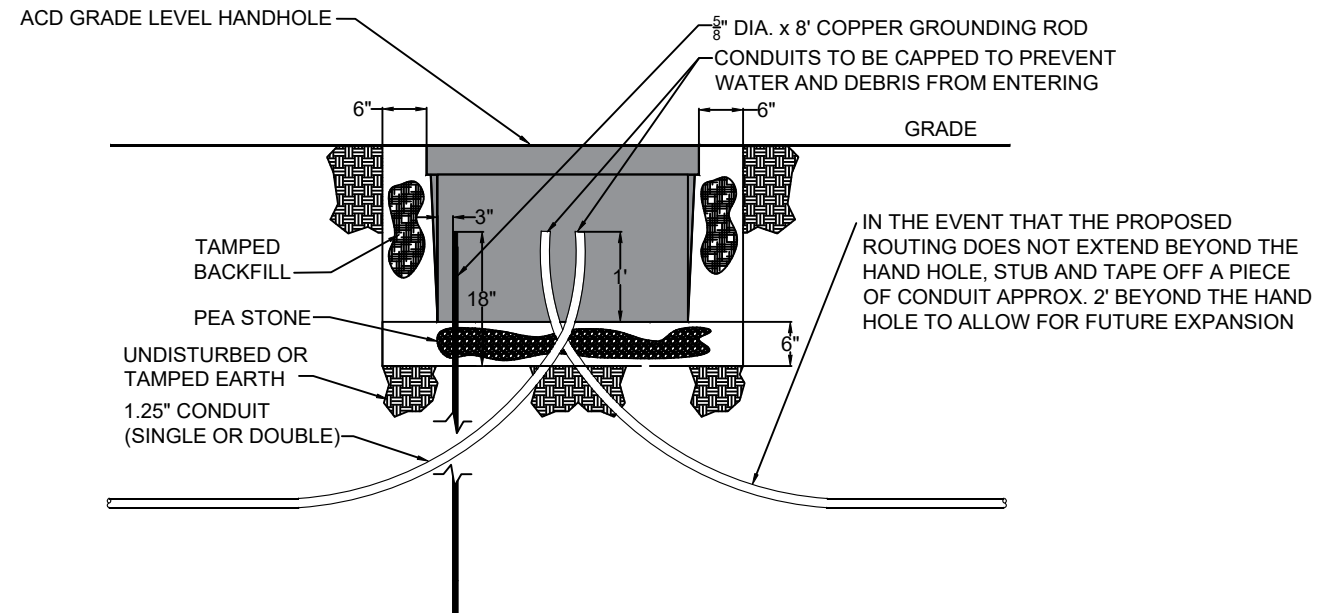
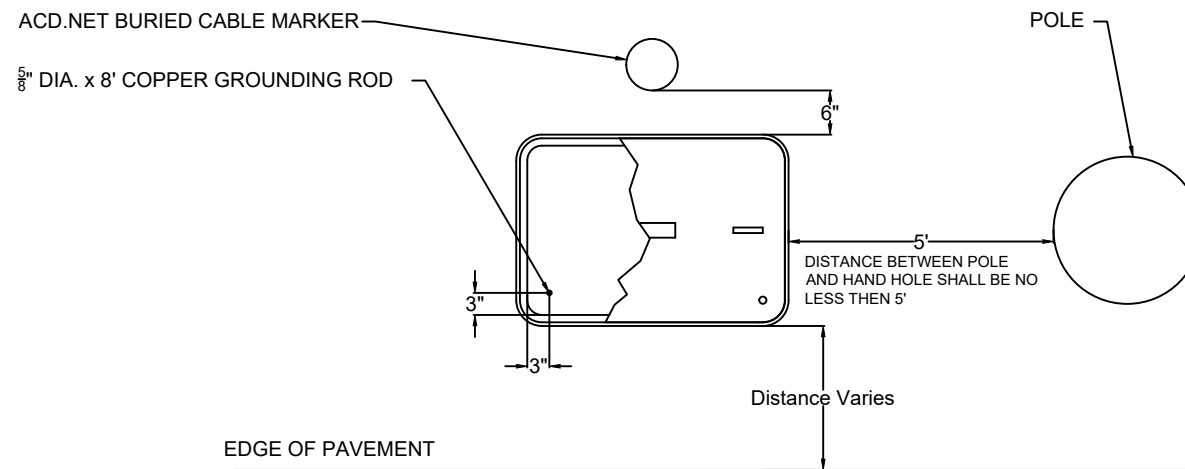

517-999-9999
 1800 Grand River Ave
 Lansing MI 48906

PROPRIETARY INFORMATION NOT FOR DISCLOSURE

This Set of Plans contains confidential or proprietary information, and the recipient must not disclose, copy, re-create, or distribute the plans or the information contained therein, either directly or indirectly, to other entities or individuals without written or express permission from ACD.NET

DRAWING DISCLAIMER

Facility Locations are general in nature, ACD.NET will not be held accountable for the accuracy of the information provided on these drawings. Contact the Local ONE CALL AGENCY 72 HOURS PRIOR TO CONSTRUCTION FOR EXACT UTILITY LOCATIONS AT:

MISS DIG 1-800-482-7171 O.U.P.S. 1-800-362-2764 INDIANA811 1-800-382-5544

CAD Standard Ver. 72919

Project Manager

T. Brown

Permitting

T. Brown

Transport Manager

G. Gould

Drawn By Date

K. Ngo 11/30/22

As Built Date

Revisions

REV #	DESCRIPTION	BY	DATE
-------	-------------	----	------

1	Moved UG Fiber to South Side of Fetch St	KN	12/16/22
---	--	----	----------

2	ROW Revision	KN	01/20/23
---	--------------	----	----------

--	--	--	--

--	--	--	--

--	--	--	--

--	--	--	--

--	--	--	--

--	--	--	--

--	--	--	--

--	--	--	--

--	--	--	--

--	--	--	--

--	--	--	--

--	--	--	--

--	--	--	--

Remarks:

PEACHTREE ID: 37972

SCALE: 1" = NTS

TRS:

COUNTY: Ottawa

TOWNSHIP: Holland

CITY:

PROJECT ID: LC011575FO037972

CUSTOMER NUMBER: 11575

HANDHOLE INSTALL

DETAIL

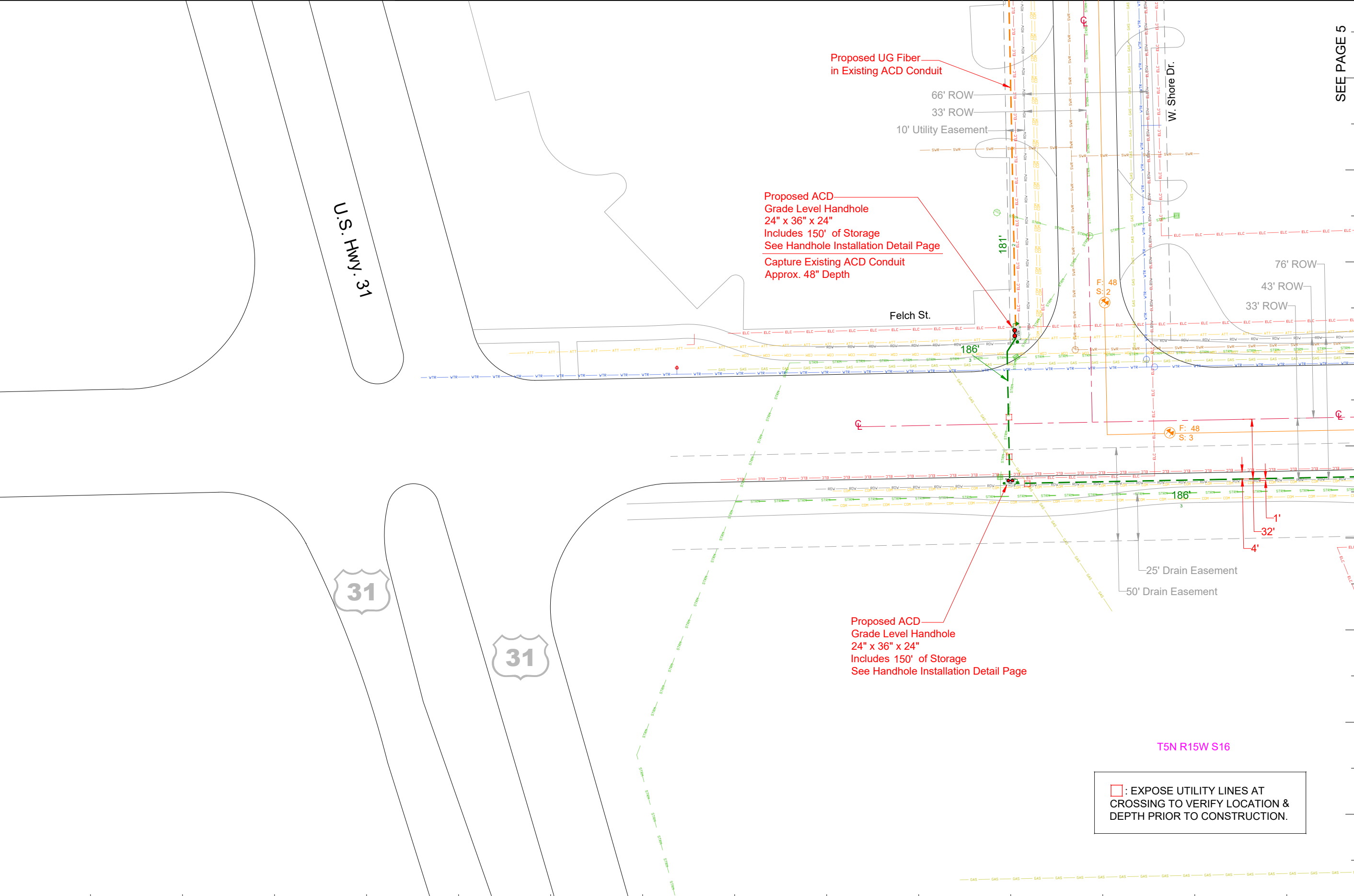

SEE PAGE 5

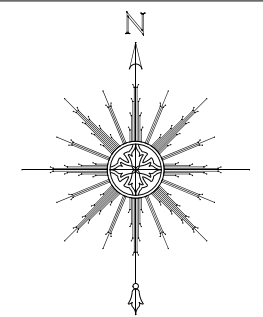

ACD.NET
 Advanced
 Communications & Data
 517-999-9999
 1800 Grand River Ave
 Lansing MI 48906

PROPRIETARY
INFORMATION NOT FOR DISCLOSURE
 This Set of Plans contains confidential or proprietary information, and the recipient must not disclose, copy, re-create, or distribute the plans or the information contained therein, either directly or indirectly, to other entities or individuals without written or express permission from ACD.NET

DRAWING DISCLAIMER
 Facility Locations are general in nature, ACD.NET will not be held accountable for the accuracy of the information provided on these drawings. Contact the Local ONE CALL AGENCY 72 HOURS PRIOR TO CONSTRUCTION FOR EXACT UTILITY LOCATIONS AT:
 MISS DIG: 1-800-482-7171
 O.U.P.S.: 1-800-362-2764
 INDIANA811: 1-800-382-5544
 CAD Standard Ver. 7.2919

Project Manager	
T. Brown	
Permitting	
T. Brown	
Transport Manager	
G. Gould	
Drawn By	Date
K. Ngo	11/30/22
As Built	Date

Revisions			
REV #	DESCRIPTION	BY	DATE
1	Moved UG Fiber to South Side of Felch St	KN	12/16/22
2	ROW Revision	KN	01/20/23

Exhibit: N/A

Remarks:			PEACHTREE ID: 37972	
SCALE: 1" = 50'	TRS: T5N R15W S16			
COUNTY: Ottawa	TOWNSHIP: Holland	CITY:	PROJECT ID: LC011575FO037972	CUSTOMER NUMBER: 11575

SEE PAGE 4

SEE PAGE 3

SEE PAGE 6

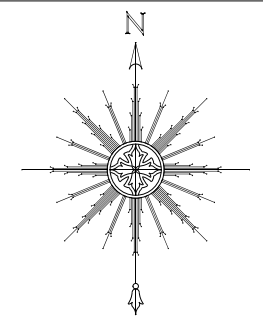
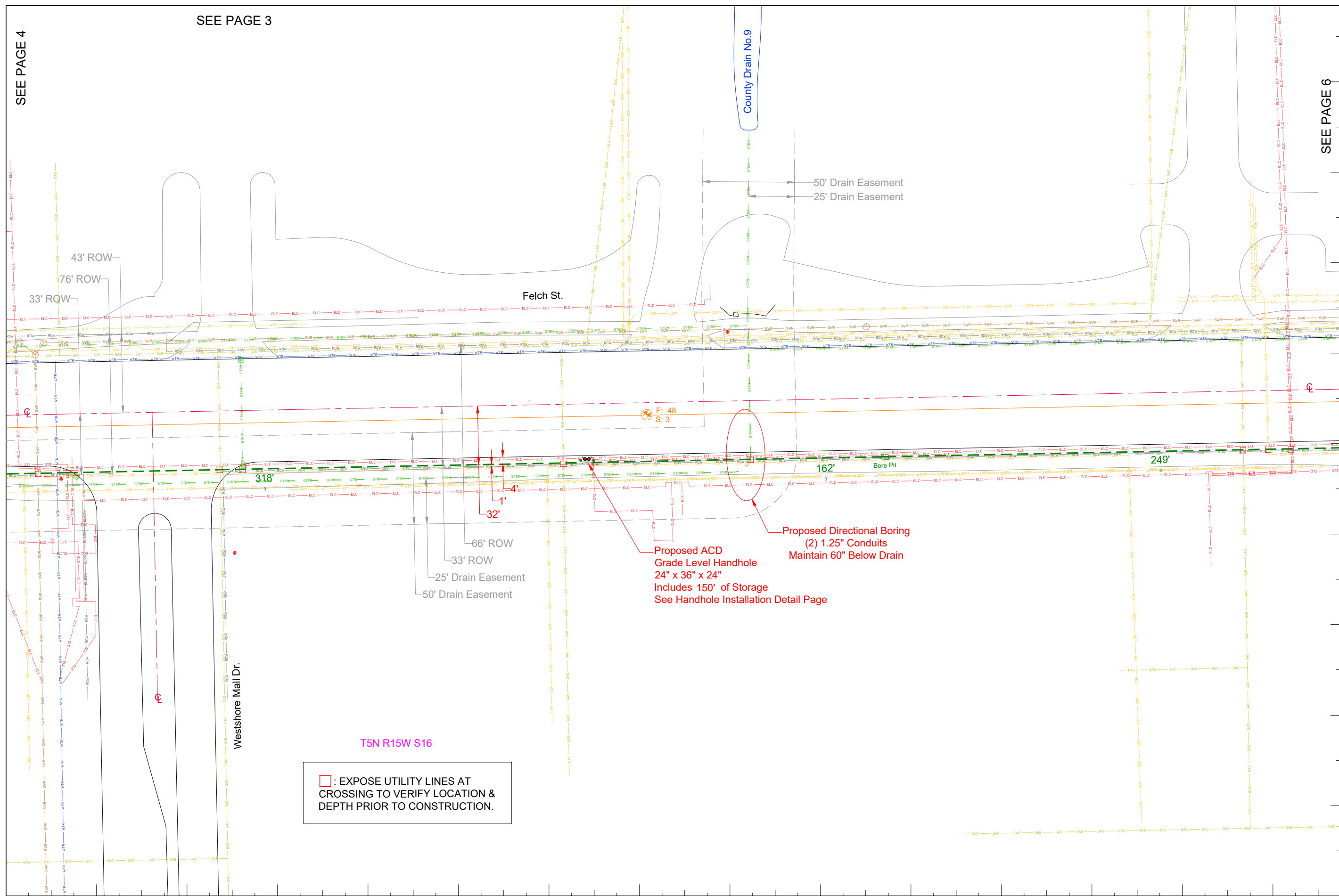

517-999-9999
 1800 Grand River Ave
 Lansing MI 48906

PROPRIETARY
INFORMATION NOT FOR DISCLOSURE

This Set of Plans contains confidential or proprietary information, and the recipient must not disclose, copy, re-create, or distribute the plans or the information contained therein, either directly or indirectly, to other entities or individuals without written or express permission from ACD.NET

DRAWING DISCLAIMER

Facility Locations are general in nature, ACD.NET will not be held accountable for the accuracy of the information provided on these drawings. Contact the Local ONE CALL AGENCY 72 HOURS PRIOR TO CONSTRUCTION FOR EXACT UTILITY LOCATIONS AT:

MISS DIG 1-800-482-7171 O.U.P.S. 1-800-362-2764 INDIANA811 1-800-382-5544
 CAD Standard Ver. 72919

Project Manager

T. Brown

Permitting

T. Brown

Transport Manager

G. Gould

Drawn By **Date**

K. Ngo 11/30/22

As Built **Date**

Revisions

REV #	DESCRIPTION	BY	DATE
1	Moved UG Fiber to South Side of Felch St	KN	12/16/22
2	ROW Revision	KN	01/20/23

☐ : EXPOSE UTILITY LINES AT CROSSING TO VERIFY LOCATION & DEPTH PRIOR TO CONSTRUCTION.

Remarks: PEACHTREE ID: 37972

SCALE: 1" = 50' TRS: T5N R15W S16

COUNTY: Ottawa TOWNSHIP: Holland CITY: PROJECT ID: LC011575FO037972 CUSTOMER NUMBER: 11575

SEE PAGE 7

PROPOSED PLOWING/HAND DIG
 (1) 1.25" Conduit
 48" Standard Depth
 12" Clearance Of All Utilities

SEE PAGE 5

PROPOSED DIRECTIONAL BORING
 (1) 1.25" Conduit
 48" Standard Depth
 12" Clearance Of All Utilities

Construction note:
 Placing a vault
 for customer

PROPOSED DIRECTIONAL BORING
 (2) 1.25" Conduits
 48" Standard Depth
 12" Clearance Of All Utilities

PROPOSED DIRECTIONAL BORING
 (1) 1.25" Conduit
 48" Standard Depth
 12" Clearance Of All Utilities

Proposed ACD
 Grade Level Handhole
 24" x 36" x 24"
 Includes 150' of Storage
 See Handhole Installation Detail Page

□ : EXPOSE UTILITY LINES AT
CROSSING TO VERIFY LOCATION &
DEPTH PRIOR TO CONSTRUCTION.

T5N R15W S16

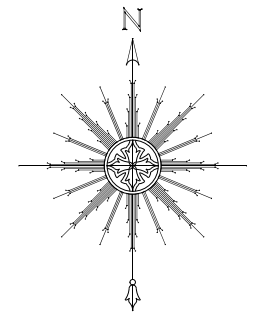

Communications & Data
 517-999-9999
 1800 Grand River Ave
 Lansing MI 48906

PROPRIETARY
INFORMATION NOT FOR
DISCLOSURE

This Set of Plans contains confidential or proprietary information, and the recipient must not disclose, copy, re-create, or distribute the plans or the information contained therein, either directly or indirectly, to other entities or individuals without written or express permission from ACD.NET

DRAWING DISCLAIMER

Facility Locations are general in nature, ACD.NET will not be held accountable for the accuracy of the information provided on these drawings. Contact the Local ONE CALL AGENCY 72 HOURS PRIOR TO CONSTRUCTION FOR EXACT UTILITY LOCATIONS AT:

MISS DIG 1-800-482-7171	O.U.P.S. 1-800-362-2764	INDIANA811 1-800-382-5544
----------------------------	----------------------------	------------------------------

CAD Standard Ver. 72919

Project Manager

T. Brown

Permitting

T. Brown

Transport Manager

G. Gould

Drawn By **Date**

K. Ngo 11/30/22

As Built **Date**

Revisions

REV #	DESCRIPTION	BY	DATE
1	Moved UG Fiber to South Side of Felch St	KN	12/16/22
2	ROW Revision	KN	01/20/23

Exhibit: N/A

Remarks:
 SCALE: 1" = 50'
 COUNTY: Ottawa TOWNSHIP: Holland CITY: PROJECT ID: LC011575FO037972

PEACHTREE ID: 37972
PAGE 6
 CUSTOMER NUMBER: 11575

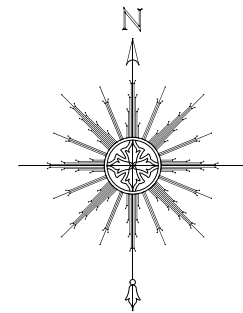

ACD_{NET}
 Advanced
 Communications & Data
 517-999-9999
 1800 Grand River Ave
 Lansing MI 48906

**PROPRIETARY
 INFORMATION NOT FOR
 DISCLOSURE**

This Set of Plans contains confidential or proprietary information, and the recipient must not disclose, copy, re-create, or distribute the plans or the information contained therein, either directly or indirectly, to other entities or individuals without written or express permission from ACD.NET

DRAWING DISCLAIMER

Facility Locations are general in nature, ACD.NET will not be held accountable for the accuracy of the information provided on these drawings. Contact the Local ONE CALL AGENCY 72 HOURS PRIOR TO CONSTRUCTION FOR EXACT UTILITY LOCATIONS AT:

MISS DIG 1-800-482-7171	O.U.P.S. 1-800-362-2764	INDIANA811 1-800-382-5544
----------------------------	----------------------------	------------------------------

CAD Standard Ver. 72919

Project Manager

T. Brown

Permitting

T. Brown

Transport Manager

G. Gould

Drawn By **Date**

K. Ngo 11/30/22

As Built **Date**

Revisions

REV #	DESCRIPTION	BY	DATE
1	Moved UG Fiber to South Side of Felch St	KN	12/16/22
2	ROW Revision	KN	01/20/23

Exhibit: N/A

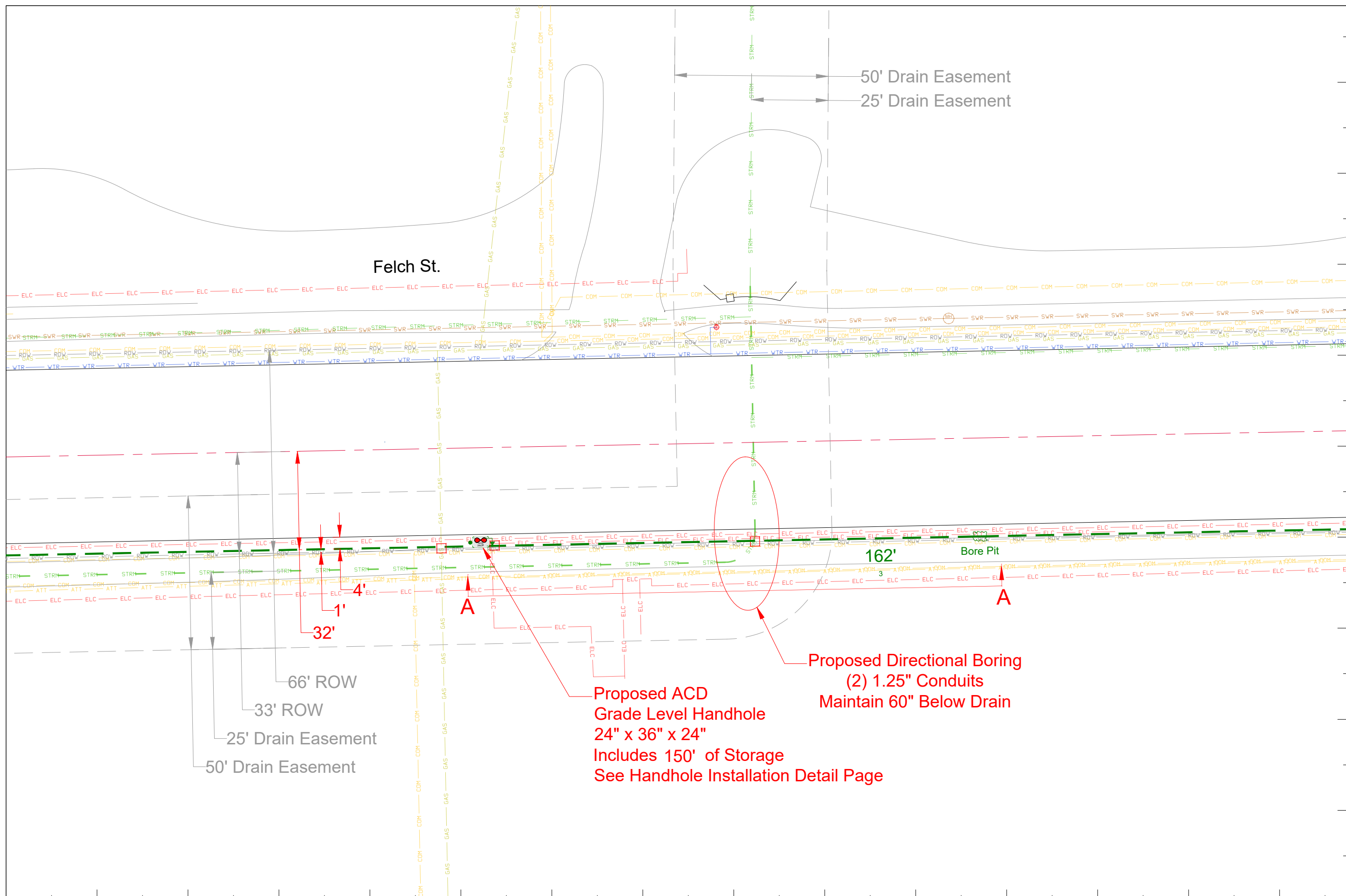

Remarks: PEACHTREE ID: 37972

SCALE: 1" = NTS TRS: T5N R15W S16

COUNTY: Ottawa TOWNSHIP: Holland CITY: PROJECT ID: LC011575FO037972 CUSTOMER NUMBER: 11575

DRAIN ELEVATION
AERIAL VIEW
FELCH ST

FELCH STREET DRAIN CROSSING

VIEW IS LOOKING NORTH

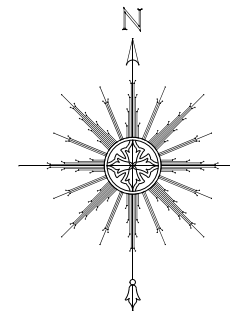

Communications & Data
517-999-9999
1800 Grand River Ave
Lansing MI 48906

PROPRIETARY
INFORMATION NOT FOR DISCLOSURE

This Set of Plans contains confidential or proprietary information, and the recipient must not disclose, copy, re-create, or distribute the plans or the information contained therein, either directly or indirectly, to other entities or individuals without written or express permission from ACD.NET

DRAWING DISCLAIMER

Facility Locations are general in nature, ACD.NET will not be held accountable for the accuracy of the information provided on these drawings. Contact the Local ONE CALL AGENCY 72 HOURS PRIOR TO CONSTRUCTION FOR EXACT UTILITY LOCATIONS AT:

MISS DIG 1-800-482-7171	O.U.P.S. 1-800-362-2764	INDIANA811 1-800-382-5544
----------------------------	----------------------------	------------------------------

CAD Standard Ver. 72919

Project Manager

T. Brown

Permitting

T. Brown

Transport Manager

G. Gould

Drawn By	Date
K. Ngo	11/30/22

As Built	Date

Revisions

REV #	DESCRIPTION	BY	DATE
1	Moved UG Fiber to South Side of Felch St	KN	12/16/22
2	ROW Revision	KN	01/20/23

Exhibit: N/A

DRAIN CROSSING

ELEVATION VIEW

FELCH ST

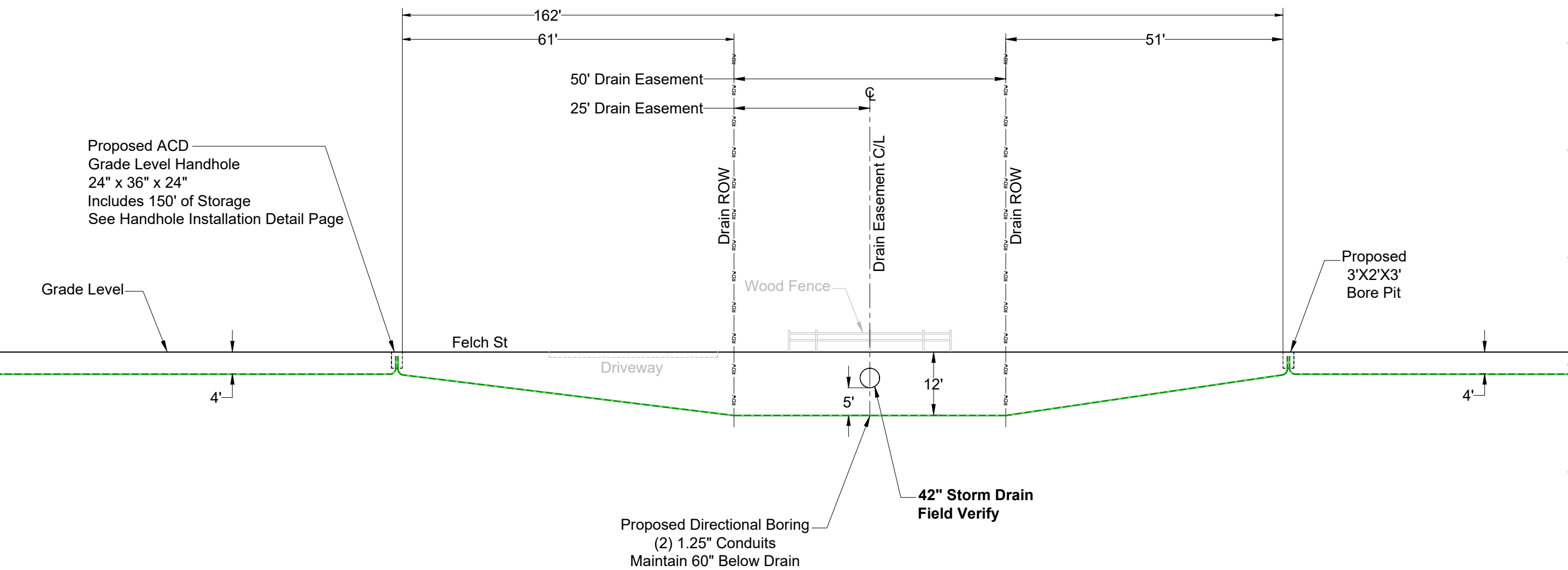

Proposed ACD
Grade Level Handhole
24" x 36" x 24"
Includes 150' of Storage
See Handhole Installation Detail Page

Grade Level

Felch St

Driveway

Wood Fence

Proposed
3'X2'X3'
Bore Pit

42" Storm Drain
Field Verify

Proposed Directional Boring
(2) 1.25" Conduits
Maintain 60" Below Drain

A-A ELEVATION VIEW

Remarks:	PEACHTREE ID: 37972
SCALE: 1" = NTS	TRS: T5N R15W S16
COUNTY: Ottawa	TOWNSHIP: Holland
CITY:	PROJECT ID: LC011575FO037972
	CUSTOMER NUMBER: 11575